

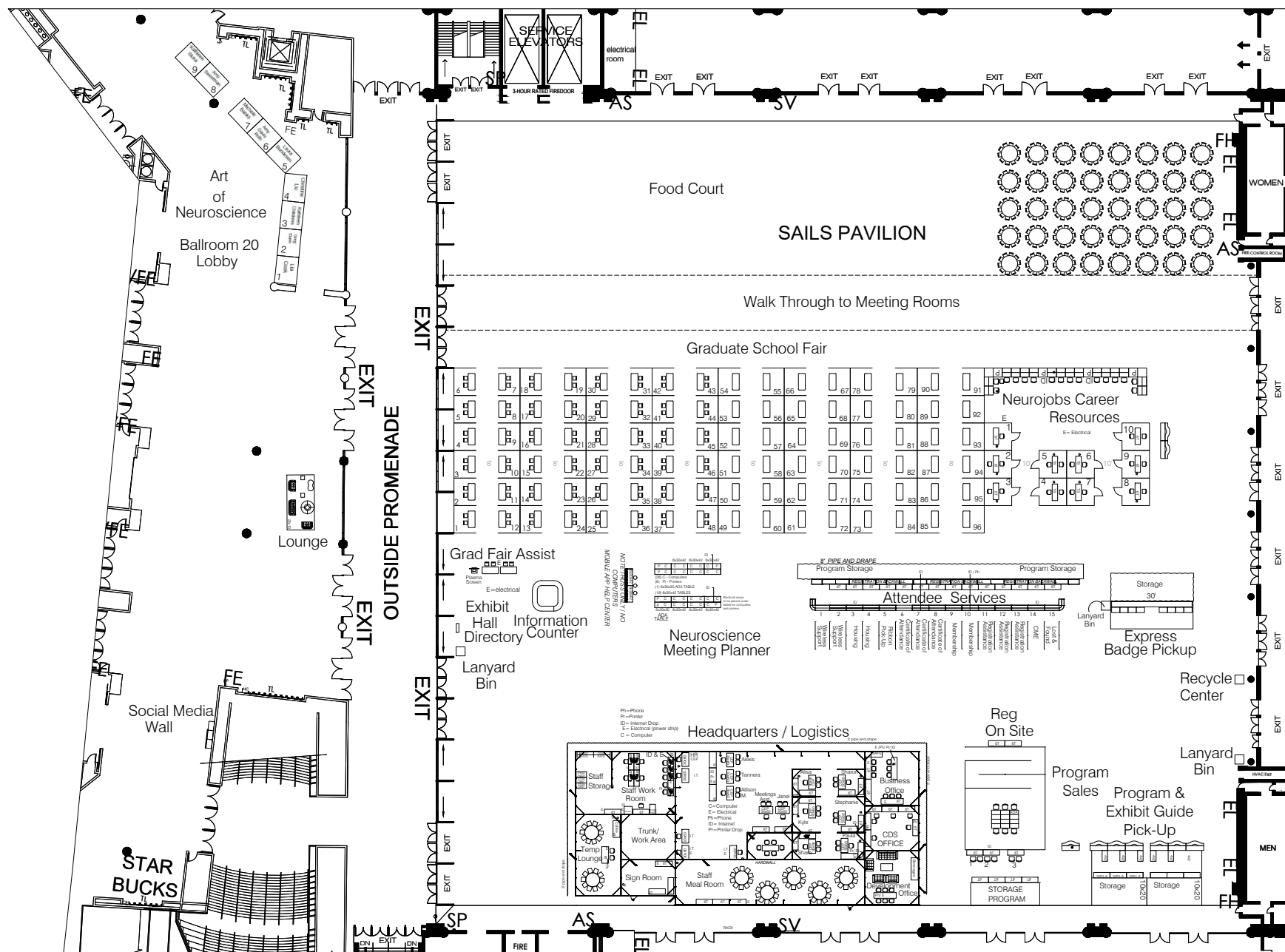

Sails Pavilion / Ballroom 20 Lobby



*This floor plan is subject to fire marshal approval.

■ Current As Of: 09/19/2018
 ■ Job No.: 811002
 ■ Drawn By: SA
 ■ Scale: Fit To Page

C:\ITEG\LAPTOP-CAD\SN18-UL.dwg

Society for Neuroscience 2018
 Meeting Dates: November 3-7 Exhibit Dates: November 4-7
 San Diego Convention Center
 Upper Level - Sails Pavilion
 San Diego, California

THE EXPO GROUP

YOUR SINGLE SOURCE SOLUTION™
 5931 CAMPUS CIRCLE DR, IRVING, TEXAS 75063
 VOICE: (972) 580-9000, FAX: (972) 753-0008

Disclaimer

Every effort has been made to ensure the accuracy of all information contained on this floor plan. However no warranties, either expressed or implied are made with respect to this floor plan. If the location of building columns, utilities or other architectural components of the facility is a consideration in the construction or usage of an exhibit, it is the sole responsibility of the exhibitor to physically inspect the facility to verify all dimensions and locations.

Headquarters / Logistics Office

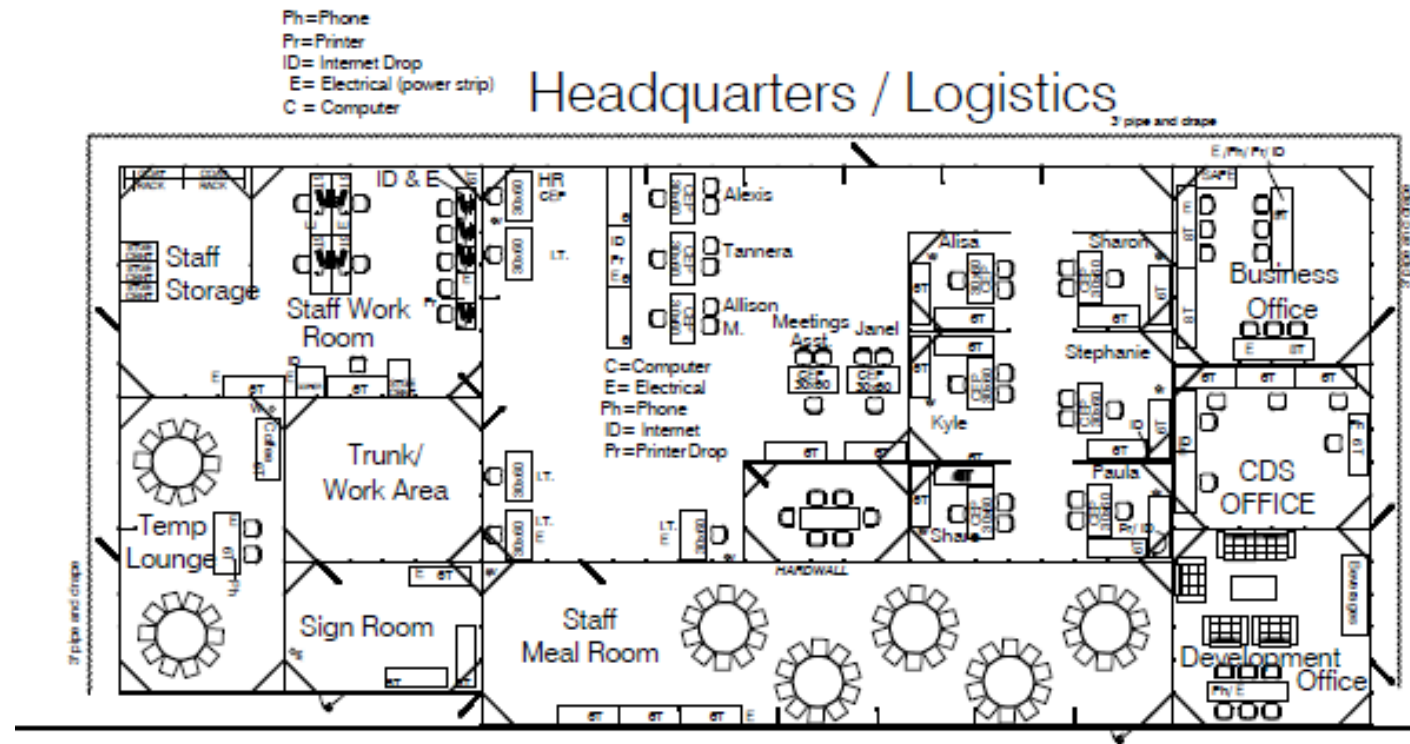

Logistics Office

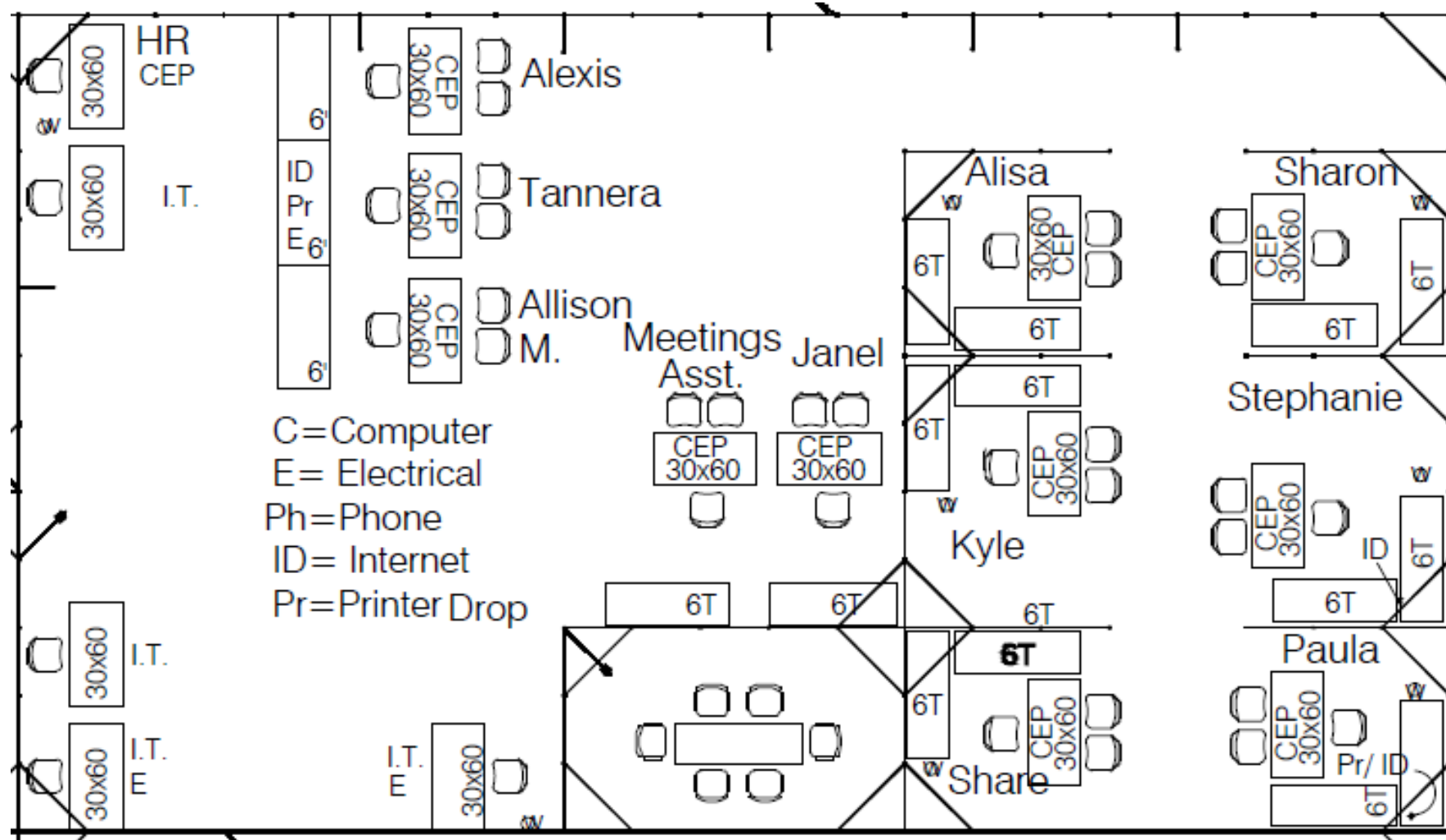

Ph=Phone
Pr=Printer
ID= Internet Drop
E= Electrical (power strip)
C = Computer

Staff Meal Room

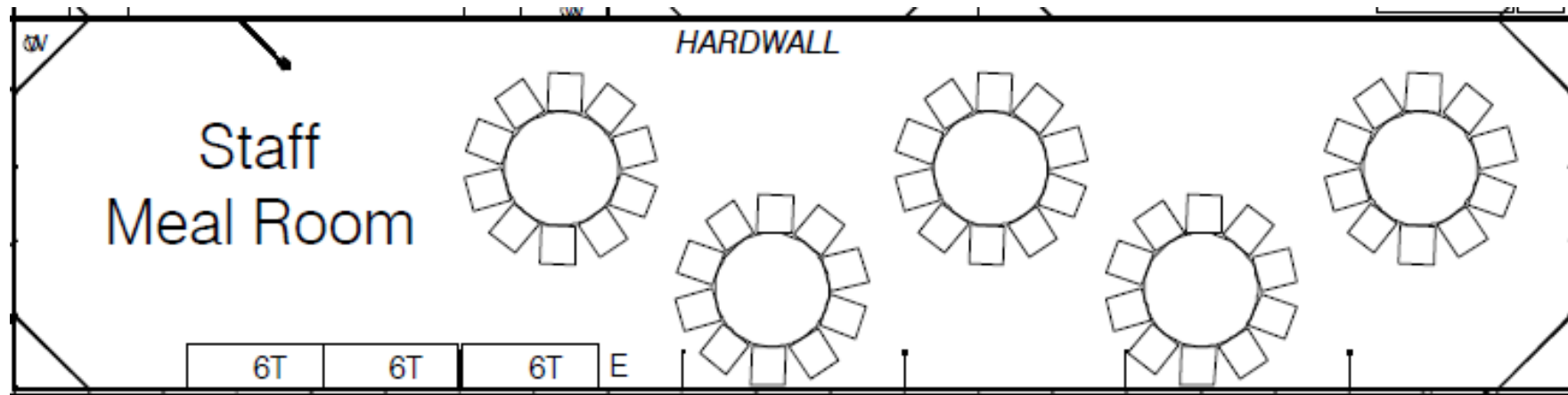

Staff Storage/Work Room

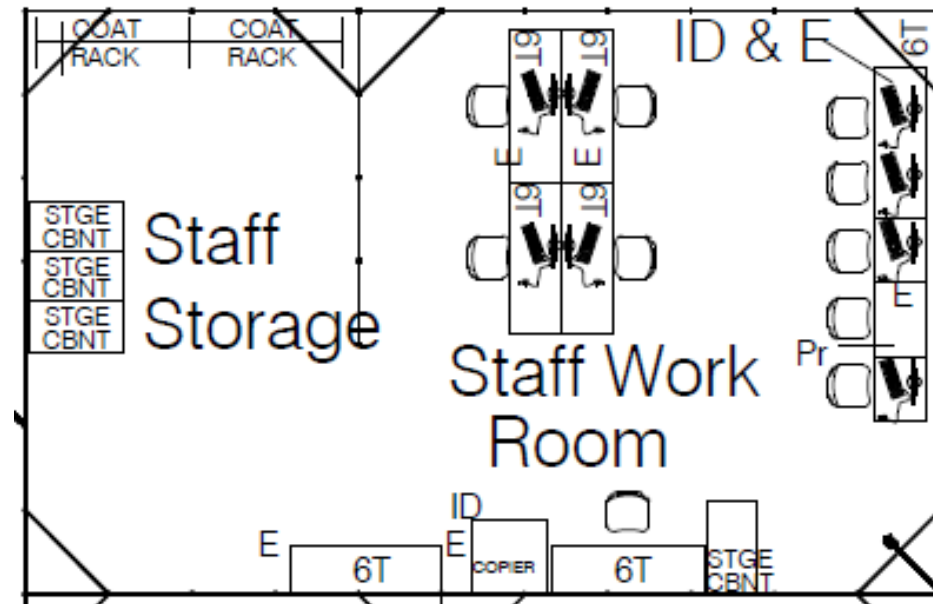

Sign Room and Trunk/Work Area

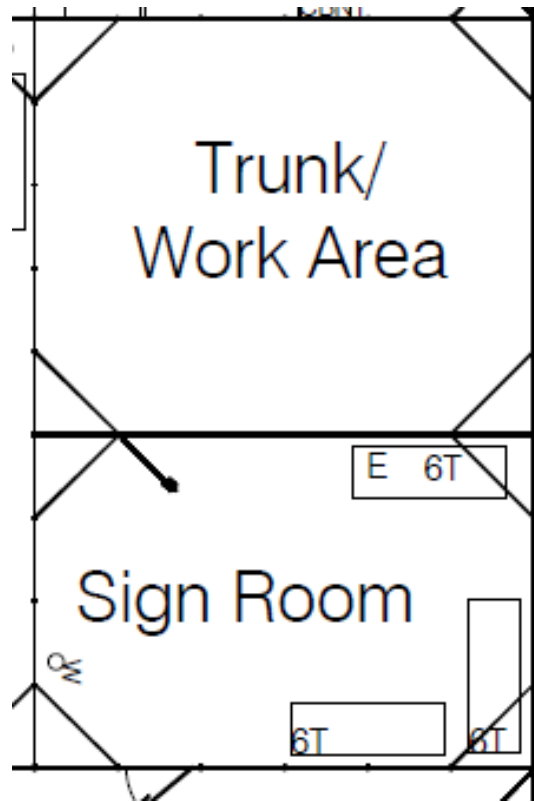

Temp Lounge

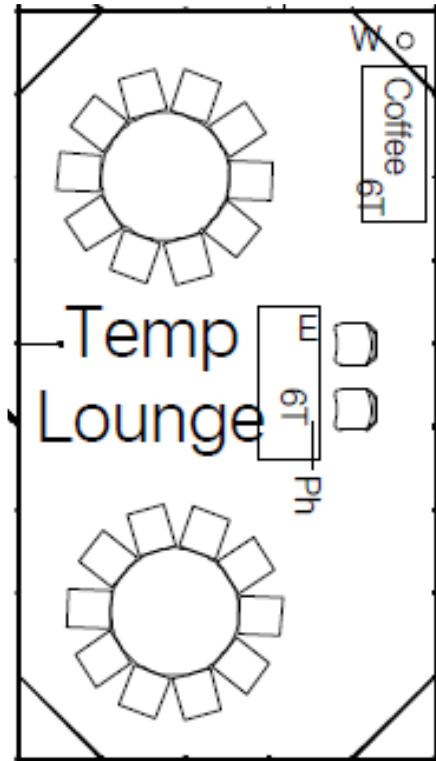

Business Office

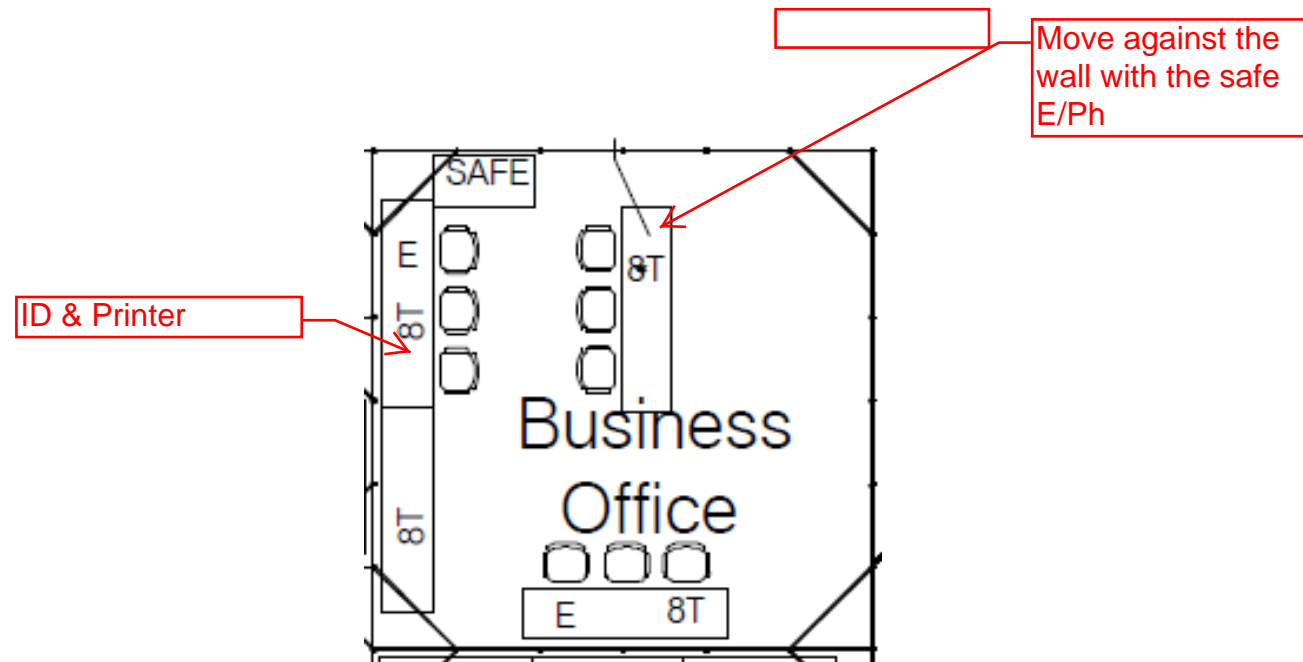

CDS Office

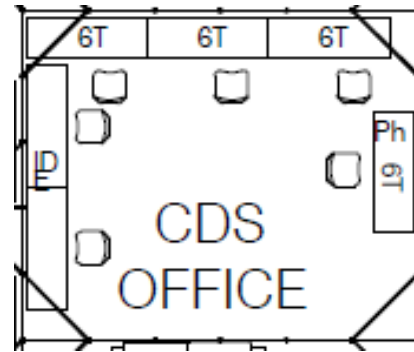

Development Office

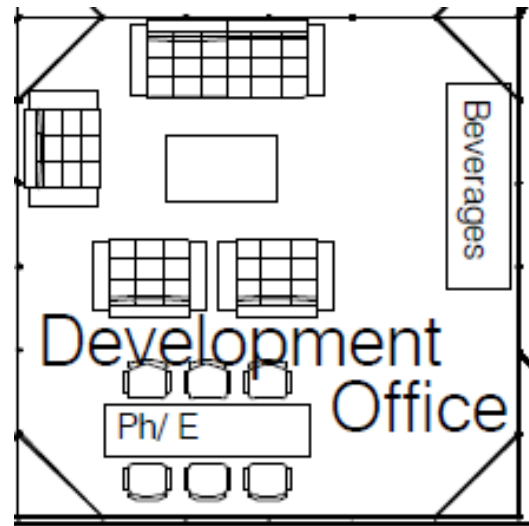

Graduate School Fair

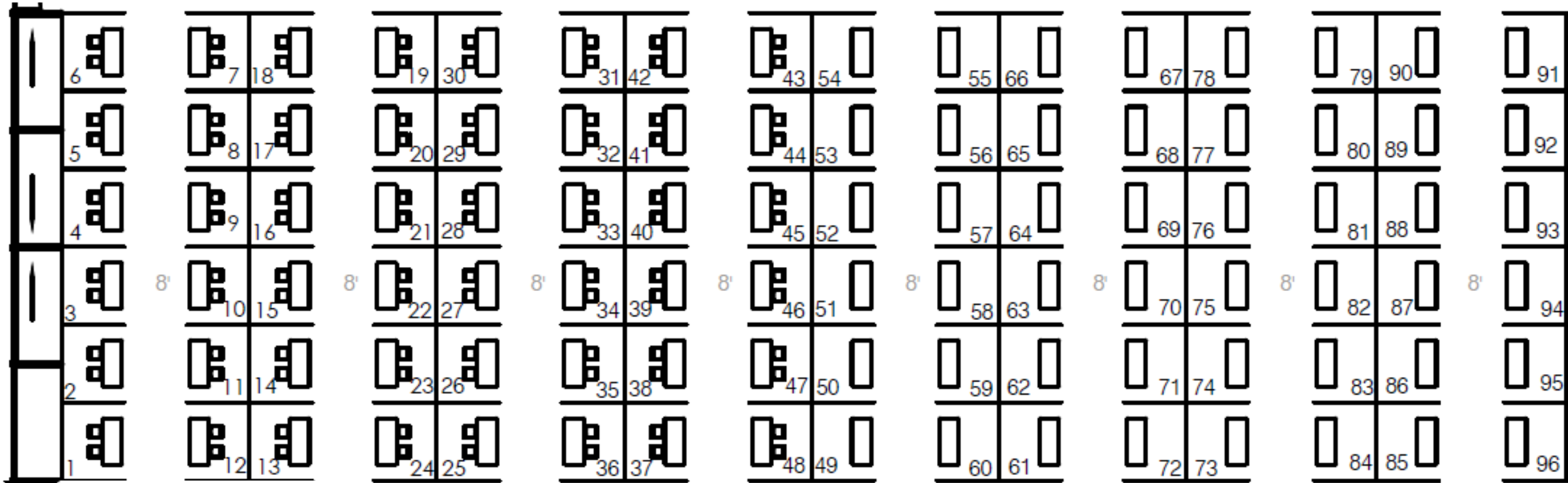

Grad Fair Assist



Plasma
Screen

E=electrical



Mobile App Help Desk / Neuroscience Meeting Planner

MOBILE APP HELP CENTER
COMPUTERS
NOTE: IRUSS ONLY / NO



6x30x42		6x30x42		6x30x42		ID
P	C	C	C	C	C	P
P	C	C	C	C	C	C

(26) C - Computers

(6) Pr - Printers

(1) 6x30x30 ADA TABLE

(19) 6x30x42 TABLES

6x30x30		6x30x42		6x30x42		6x30x42	ID
P	C	C	C	C	C	C	
P	C	C	C	C	C	P	

ADA
TABLE

Electrical drops
to be placed under
tables for computers
and printers

Attendee Services

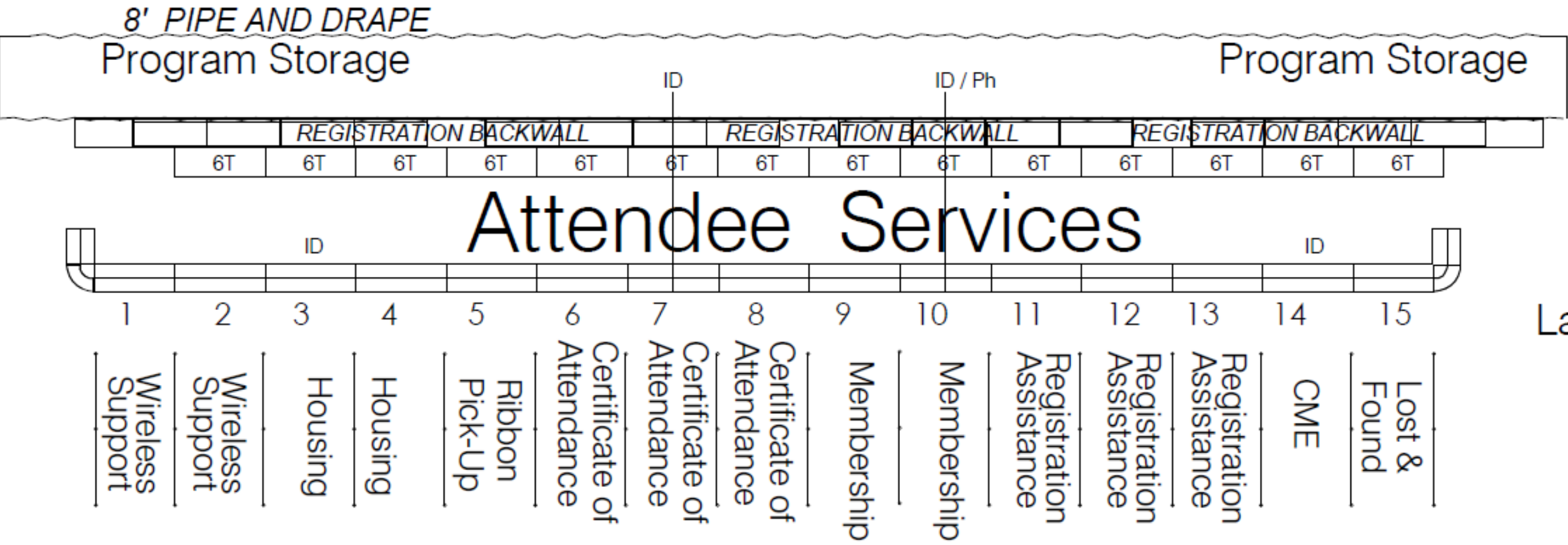

Express Badge Pickup

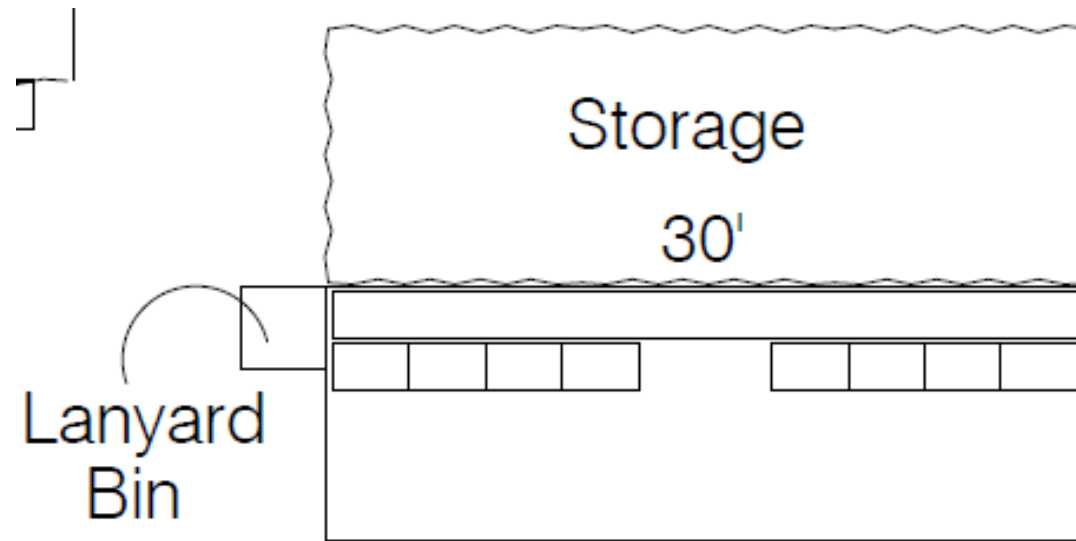

Express Badge Pickup

Program Sales and Program / Exhibit Guide Pick-Up

Program Sales Program &
Exhibit Guide
Pick-Up

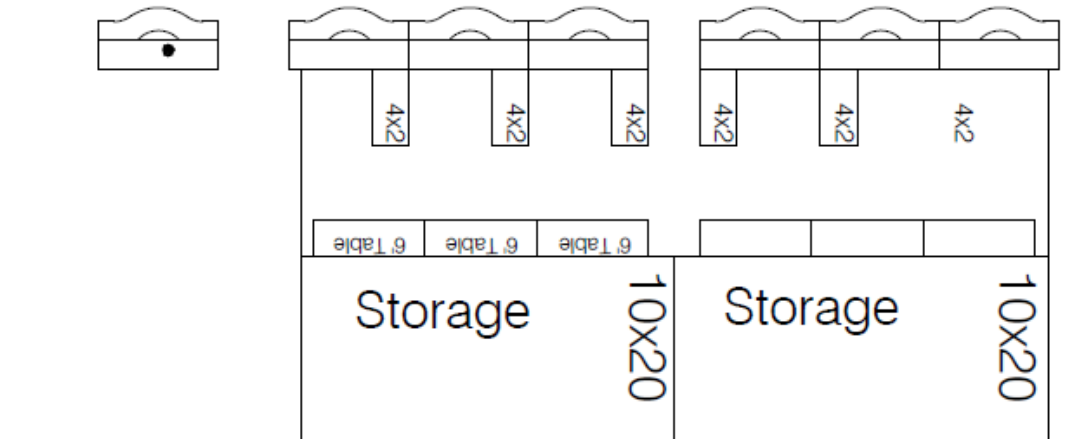

The diagram illustrates a storage program layout for a 6T system. It features a large rectangular area divided into two horizontal sections. The top section is labeled '6T' and contains a grid of 12 cells (3 rows by 4 columns). The bottom section is labeled '6T' and contains a grid of 12 cells (3 rows by 4 columns). The grid in the bottom section is labeled 'ADA' in the top-left cell. To the right of the grid, there are three labels: '1', '2', and '3', each followed by a '6T' label. The '1' label is positioned above the first column of the grid, the '2' label is positioned above the second column, and the '3' label is positioned above the third column. The '6T' label is positioned to the right of the third column. The entire diagram is enclosed in a rectangular border.

Neurojobs

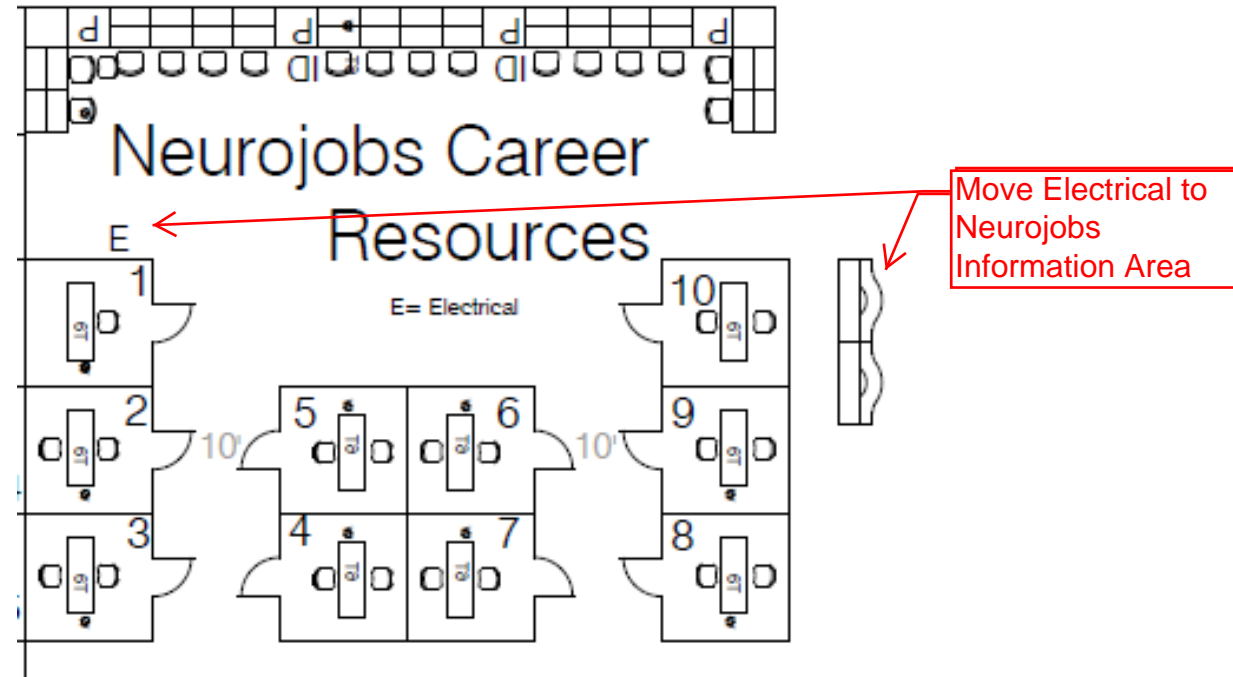

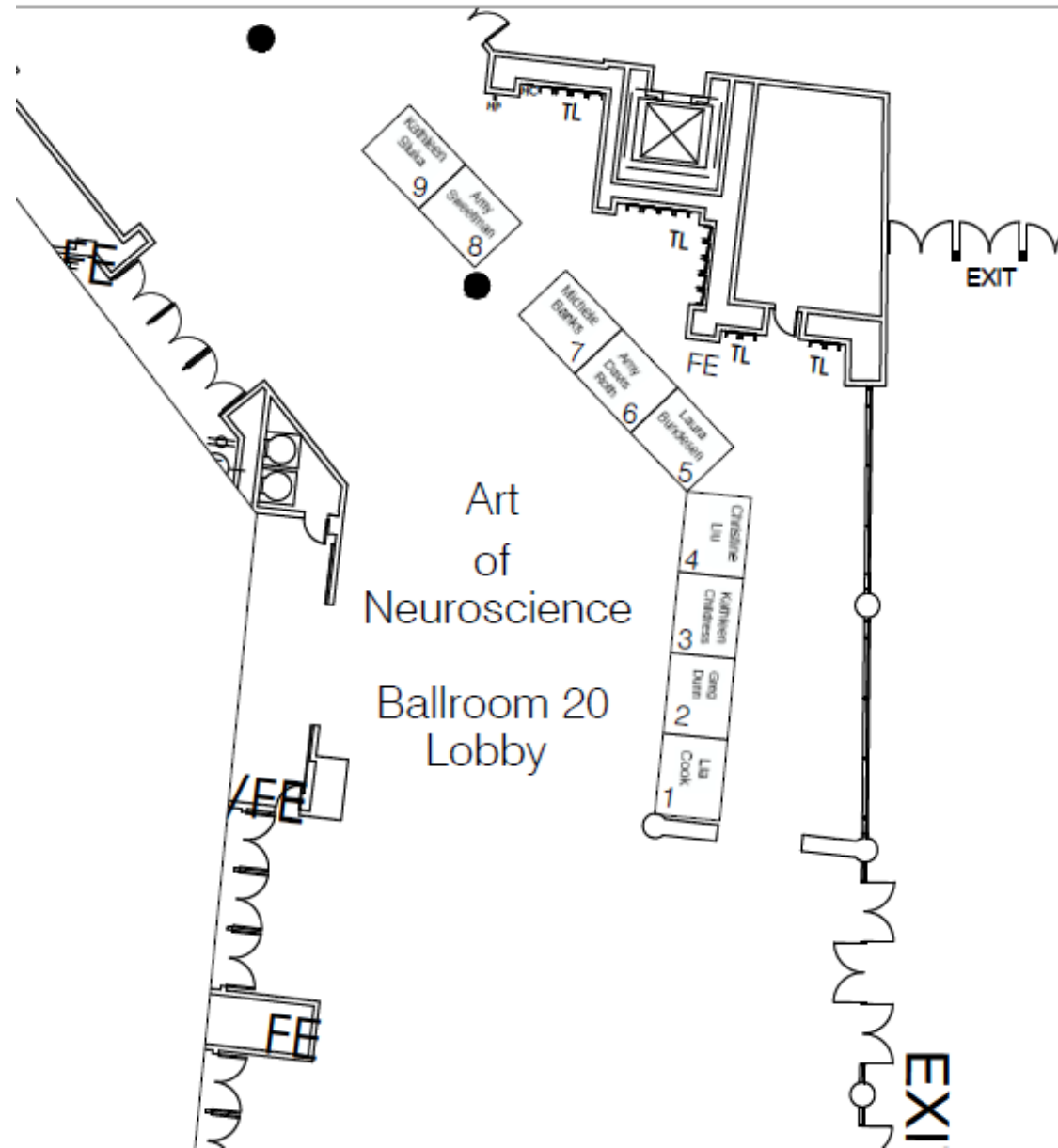

Lounge / Social Media Wall Ballroom 20 Lobby

